

650nm In Line Polarizer

650nm In Line Polarizer is a fiber optic passive component which can be used for converting the non polariaered light to a polarized light, it only allows the polarization light that paralleled to the polarizer to pass and block the other polarization, it also can be used to enhance extinction ratio of the polarization light. High power type is also available upon request.

Application:

Fiber Optic Amplifier
Fiber Optic Sensor
Fiber Laser
Lab And Research

Features:

High Extinction Ratio
High Power Available
Low Insertion Loss
High Reliability

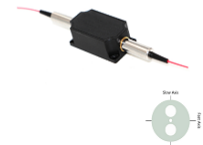

Specification:

Parameter	Symbol	Value	Unit
Center Wavelength	λ	650	nm
Bandwidth	BW	± 10	nm
Typ. Insertion Loss	IL	1.2	dB
Max. Insertion Loss	IL	1.5	dB
Typ. Extinction Ratio	ER	24	dB
Min. Extinction Ratio	ER	22	dB
Min. Return Loss	RL	50	dB
Max. Optical Power (CW)	P	300	mW
Max. Tensile Load		5	N
Fiber Type		PM 630-HP fiber or SM 630-HP fiber	-
Operating Temperature	T	-5~70	°C
Storage Temperature	T	-40~85	°C
Package Dimension			mm

Notice: Above specifications are tested at center wavelength without connector in room temperature @23°C.

For devices with connectors, IL will be 0.3dB higher, RL will be 5dB lower, ER will be 2dB lower, slow axis is default aligned to the connector key.

Drawing:

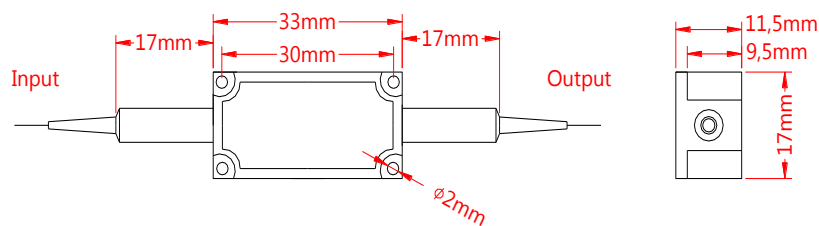

Ordering Information (Part Number):

ILP- WWW - FF - J - LL - CC				
WWW	FF	J	LL	CC
Wavelength	Fiber Type (Input/Output)	Fiber Jacket	Fiber Length	Connector
633 - 633nm	PP - PM fiber on input and output port	B - 250um Bare Fiber	05 - 0.5m	NE - None
635 - 635nm	SS - SM fiber on input and output port	9 - 900um Loose Tube	10 - 1.0m	FA - FC/APC
637 - 637nm	PS - PM fiber on input port	2 - 2.0mm Loose Tube	15 - 1.5m	FU - FC/UPC
650 - 650nm	SM fiber on output port		20 - 2.0m	SA - SC/APC
680 - 680nm	SP - SM fiber on input port		SS - Specify	SU - SU/APC
	PM fiber on output port			LA - LC/APC
				LU - LC/UPC
				SS - Specify