

780±20nm Broadband Polarization Insensitive Optical Isolator

780±20nm Broadband Polarization Insensitive Optical Isolator is a fiber passive component built with TGG crystal, it allows light signal to be delivered in one forward direction and avoid the back reflection light, it's widely used in amplifier system, fiber optic sensor system to protect the light source and lower down the system optical signal noise. The higher power type is available upon request.

Application:

Fiber Amplifier
Fiber Optic Sensor
Fiber Laser
Lab & Research

Features:

High Isolation
Wide Band
Low Insertion Loss
High Reliability



Specification:

| Parameter | Symbol | Value | Unit |
|----------------------------------|-----------|---------------------------------|------|
| Center Wavelength | λ | 780 | nm |
| Bandwidth | BW | ±20 | nm |
| Typ. Insertion Loss | IL | 0.9 | dB |
| Max. Insertion Loss | IL | 1.5 | dB |
| Typ. Peak Isolation | Iso | 35 | dB |
| Min. Isolation | Iso | 25 | dB |
| Max. Polarization Dependent Loss | PDL | 0.2 | dB |
| Min. Return Loss | RL | 50 | dB |
| Max. Optical Power (CW) | P | 500 (higher Power is available) | mW |
| Max. Tensile Load | | 5 | N |
| Fiber Type | | HI 780 fiber | - |
| Operating Temperature | T | +5~65 | °C |
| Storage Temperature | T | -40~85 | °C |
| Package Dimension | | | mm |

Notice: Above specifications are tested without connector in room temperature @23°C.

For devices with connectors, IL will be 0.3dB higher, RL will be 5dB lower.

Drawing:

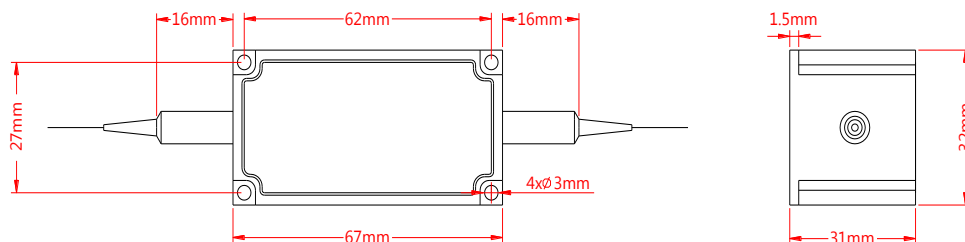

Ordering Information (Part Number):

BPIISO-*WWW*-*FF*-*J*-*LL*-*CC*

| WWW | FF | J | LL | CC |
|---------------|--------------|----------------------|--------------|--------------|
| Wavelength | Fiber Type | Fiber Jacket | Fiber Length | Connector |
| 780 - 780nm | H7 - HI 780 | B - 250um Bare Fiber | 05 - 0.5m | NE - None |
| 785 - 785nm | SS - Specify | 9 - 900um Loose Tube | 10 - 1.0m | FA - FC/APC |
| 790 - 790nm | | | 15 - 1.5m | FU - FC/UPC |
| 793 - 793nm | | | 20 - 2.0m | SA - SC/APC |
| SSS - Specify | | | SS - Specify | SU - SU/APC |
| | | | | LA - LC/APC |
| | | | | LU - LC/UPC |
| | | | | SS - Specify |