

1053±50nm Broadband Polarization Insensitive Optical Isolator

1053±50nm Broadband Polarization Insensitive Optical Isolator is a fiber passive component built with TGG crystal, it allows light signal to be delivered in one forward direction and avoid the back reflection light, it's widely used in OCT system, fiber optic sensor system to protect the light source and lower down the system optical signal noise. The higher power type is available upon request.

Application:

OCT
Fiber Optic Sensor
Fiber Laser
Lab & Research

Features:

High Isolation
Wide Band
Low Insertion Loss
High Reliability



Specification:

Parameter	Symbol	Value	Unit
Center Wavelength	λ	1053	nm
Bandwidth	BW	±50	nm
Typ. Insertion Loss	IL	0.9	dB
Max. Insertion Loss	IL	1.3	dB
Typ. Peak Isolation	Iso	25	dB
Min. Isolation	Iso	18	dB
Max. Polarization Dependent Loss	PDL	0.2	dB
Min. Return Loss	RL	50	dB
Max. Optical Power (CW)	P	500 (higher Power is available)	mW
Max. Tensile Load		5	N
Fiber Type		HI 1060 fiber	-
Operating Temperature	T	+5~65	°C
Storage Temperature	T	-40~85	°C
Package Dimension			mm

Notice: Above specifications are tested without connector in room temperature @23°C.

For devices with connectors, IL will be 0.3dB higher, RL will be 5dB lower.

Drawing:

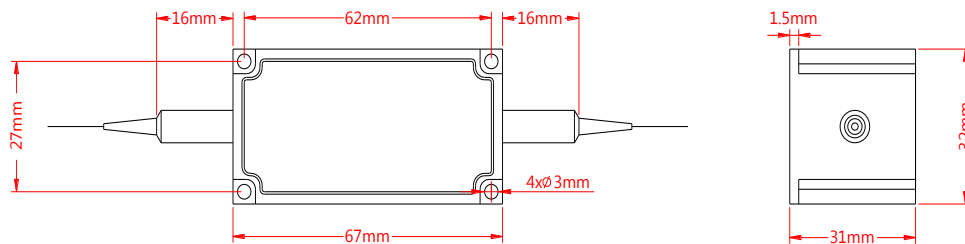

Ordering Information (Part Number):

BPIISO-WWWW-FF-J-LL-CC

WWW	FF	J	LL	CC
Wavelength	Fiber Type	Fiber Jacket	Fiber Length	Connector
1030 - 1030nm	H1 - HI 1060	B - 250um Bare Fiber	05 - 0.5m	NE - None
1040 - 1040nm	SS - Specify	9 - 900um Loose Tube	10 - 1.0m	FA - FC/APC
1050 - 1050nm			15 - 1.5m	FU - FC/UPC
1053 - 1053nm			20 - 2.0m	SA - SC/APC
1060 - 1060nm			SS - Specify	SU - SU/APC
1064 - 1064nm				LA - LC/APC
SSSS - Specify				LU - LC/UPC
				SS - Specify