

High Power 1053±50nm Broadband PM Optical Isolator

High Power 1053±50nm Broadband Polarization Maintaining Optical Isolator is a fiber passive component built with TGG crystal, it allows light signal to be delivered in one forward direction and avoid the back reflection light, it's widely used in OCT system, fiber optic sensor system to protect the light source and lower down the system optical signal noise. The higher power type is available upon request, if need pulse type please contact us to confirm.

Application:

OCT
Fiber Optic Sensor
Fiber Laser
Lab & Research

Features

High Power
High Isolation
Wide Band
High Reliability



Specification:

| Parameter | Symbol | Value | Unit |
|---|-----------|----------------------------|------|
| Center Wavelength | λ | 1053 | nm |
| Bandwidth | BW | ±50 | nm |
| Typ. Insertion Loss | IL | 0.9 | dB |
| Max. Insertion Loss | IL | 1.4 | dB |
| Typ. Peak Isolation | Iso | 25 | dB |
| Min. Isolation | Iso | 18 | dB |
| Min. Extinction Ratio for Fast Axis Blocked | ER | 20 | dB |
| Min. Extinction Ratio for Both Axes Working | ER | 18 | dB |
| Min. Return Loss | RL | 50 | dB |
| Max. Optical Power (CW) | P | 1, 3, 5, 10, 20 or specify | W |
| Max. Peak Power | P | 5, 10 or specify | KW |
| Max. Tensile Load | | 5 | N |
| Fiber Type | | PM Panda Fiber | - |
| Operating Temperature | T | +5~65 | °C |
| Storage Temperature | T | -40~85 | °C |
| Package Dimension | | | mm |

Notice: Above specifications are tested without connector in room temperature @23°C.

For devices with connectors, IL will be 0.3dB higher, RL will be 5dB lower. ER will be 2dB lower.

Slow axis is default aligned to the connector key. Connectors only 1W CW optical power guarantee.

Drawing:

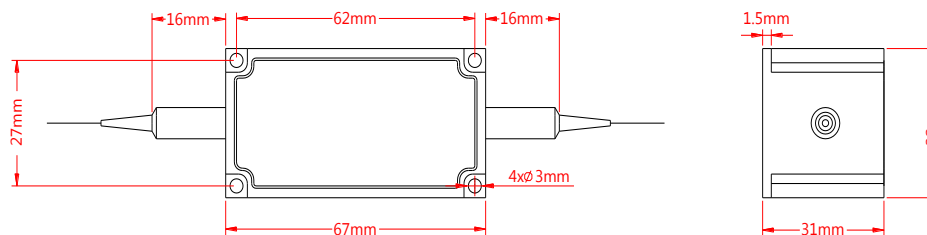

Ordering Information (Part Number):

HBPMI-**WWW**-**A**-**HH**-**J**-**LL**-**CC**

| WWW | A | HH | J | LL | CC |
|----------------|-----------------------|----------------|----------------------|--------------|--------------|
| Wavelength | Working Axis | Handling Power | Fiber Jacket | Fiber Length | Connector |
| 1030 - 1030nm | F - Fast axis Blocked | 01 - 1W | B - 250um Bare Fiber | 05 - 0.5m | NE - None |
| 1040 - 1040nm | Slow Axis working | 03 - 3W | 9 - 900um Loose Tube | 10 - 1.0m | FA - FC/APC |
| 1050 - 1050nm | B - Both Axes Working | 05 - 5W | | 15 - 1.5m | FU - FC/UFC |
| 1053 - 1053nm | | 10 - 10W | | 20 - 2.0m | SA - SC/APC |
| 1060 - 1060nm | | 20 - 20W | | SS - Specify | SU - SU/APC |
| 1064 - 1064nm | | SS - Specify | | | LA - LC/APC |
| SSSS - Specify | | | | | LU - LC/UFC |
| | | | | | SS - Specify |