

High Power 1050±50nm Broadband PM Optical Isolator

High Power 1050± 50nm Broadband Polarization Maintaining Optical Isolator is a fiber passive component built with TGG crystal, it allows light signal to be delivered in one forward direction and avoid the back reflection light, it's widely used in OCT system, fiber optic sensor system to protect the light source and lower down the system optical signal noise. The higher power type is available upon request, if need pulse type please contact us to confirm.

Application:

OCT
Fiber Optic Sensor
Fiber Laser
Lab & Research

Features

High Power
High Isolation
Wide Band
High Reliability



Specification:

Parameter	Symbol	Value	Unit
Center Wavelength	λ	1050	nm
Bandwidth	BW	±50	nm
Typ. Insertion Loss	IL	0.9	dB
Max. Insertion Loss	IL	1.4	dB
Typ. Peak Isolation	Iso	25	dB
Min. Isolation	Iso	18	dB
Min. Extinction Ratio for Fast Axis Blocked	ER	20	dB
Min. Extinction Ratio for Both Axes Working	ER	18	dB
Min. Return Loss	RL	50	dB
Max. Optical Power (CW)	P	1, 3, 5, 10, 20 or specify	W
Max. Peak Power	P	5, 10 or specify	KW
Max. Tensile Load		5	N
Fiber Type		PM Panda Fiber	-
Operating Temperature	T	+5~65	°C
Storage Temperature	T	-40~85	°C
Package Dimension			mm

Notice: Above specifications are tested without connector in room temperature @23°C.

For devices with connectors, IL will be 0.3dB higher, RL will be 5dB lower. ER will be 2dB lower.

Slow axis is default aligned to the connector key. Connectors only 1W CW optical power guarantee.

Drawing:

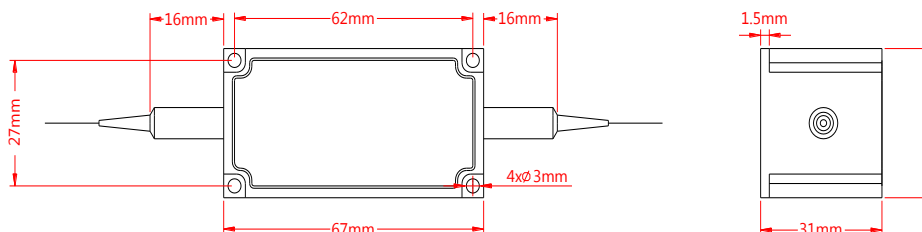

Ordering Information (Part Number):

HBPMI-**WWW**-**A**-**HH**-**J**-**LL**-**CC**

WWW	A	HH	J	LL	CC
Wavelength	Working Axis	Handling Power	Fiber Jacket	Fiber Length	Connector
1030 - 1030nm	F - Fast axis Blocked	01 - 1W	B - 250um Bare Fiber	05 - 0.5m	NE - None
1040 - 1040nm	Slow Axis working	03 - 3W	9 - 900um Loose Tube	10 - 1.0m	FA - FC/APC
1050 - 1050nm	B - Both Axes Working	05 - 5W		15 - 1.5m	FU - FC/UPC
1053 - 1053nm		10 - 10W		20 - 2.0m	SA - SC/APC
1060 - 1060nm		20 - 20W		SS - Specify	SU - SU/APC
1064 - 1064nm		SS - Specify			LA - LC/APC
SSSS - Specify					LU - LC/UPC
					SS - Specify