

## 1060nm PM Tunable Optical Filter

1060nm PM Tunable Optical Filter is a fiber passive component which can be used for filter out variable wavelength range

from a wide wavelength bandwidth, it's based on thin film cavity filter technology, the demanded wavelength can be filtered out precisely by adjusting the manual screw. Wavelength can be tuned continuously over a wide spectral range up to 80nm,

### Application:

Testing System  
Fiber Optic Sensor  
ASE Control  
Lab & Research

### Features:

Low Insertion Loss  
High Resolution  
Wide Tuning Range  
High Reliability



### Specification:

Parameter	Symbol	Value	Unit
Center Wavelength	$\lambda$	1060	nm
Tuning Range		80	nm
Tuning Resolution		0.02 (min.), 0.1 (typ.)	nm
Insertion Loss	IL	4.0 (max.), 2.5 (typ.)	dB
Bandwidth @-3dB	BW	1.2 (max.), 1.0 (typ.)	nm
Typ. Bandwidth @-20dB	BW	10	nm
Extinction Ratio	ER	18 (min.), 20 (typ.)	dB
Min. Return Loss	RL	40	dB
Max. Optical Power (CW)	P	500	mW
Max. Tensile Load		5	N
Fiber Type		PM 980 Panda Fiber	-
Operating Temperature	T	0~70	°C
Storage Temperature	T	-40~85	°C
Package Dimension			mm

Notice: Above specifications are tested at center wavelength without connector in room temperature @23°C.

For devices with connectors, IL will be 0.3dB higher, ER will be 2dB lower, RL will be 5dB lower. Slow axis is default aligned to the connector key.

### Drawing:

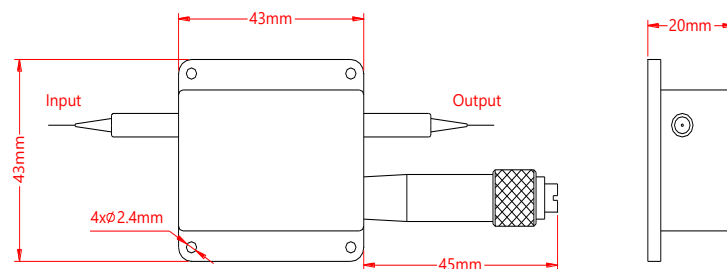

### Ordering Information (Part Number):

PMTOF- <b>WWWW</b> - <b>J</b> - <b>LL</b> - <b>CC</b>			
<b>WWWW</b>	<b>J</b>	<b>LL</b>	<b>CC</b>
Wavelength	Fiber Jacket	Fiber Length	Connector
1060 - 1060nm SSSS - Specify	B - 250um Bare Fiber 9 - 900um Loose Tube	05 - 0.5m 08 - 0.8m 10 - 1.0m 15 - 1.5m 20 - 2.0m SS - Specify	NE - None FA - FC/APC FU - FC/UPC SA - SC/APC SU - SU/APC LA - LC/APC LU - LC/UPC SS - Specify