

915nm PM Fixed In-line Optical Attenuator

915nm Polarization Maintaining (PM) Fixed In-line Optical Attenuator is a fiber component which can attenuate the optical power with a fixed attenuation value, the attenuation value can be up to 40dB, it's widely used in optical power testing system, fiber line protection and optical power monitoring field. High power type is available upon request.

Application:

Optical Power Monitoring
Fiber Line Protection
Testing System
Lab And Research

Features:

High Extinction Ratio
Low Excess Loss
High Power
High Attenuation



Specification:

| Parameter | Symbol | Value | Unit |
|---------------------------|-----------|---|--------------|
| Center Wavelength | λ | 915 | nm |
| Bandwidth | BW | ± 10 | nm |
| Typ. Excess Loss | EL | 0.5 | dB |
| Max. Excess Loss | EL | 0.7 | dB |
| Min. Extinction Ratio | ER | 20 | dB |
| Attenuation and Tolerance | | 1 \pm 0.1, 2 \pm 0.2, 3 \pm 0.3, 5 \pm 0.7, 10 \pm 1.0, 15 \pm 1.8, 20 \pm 2.5, 30 \pm 3.0, or customized | dB |
| Max. Optical Power (CW) | P | 2 | W |
| Max. Tensile Load | | 5 | N |
| Fiber Type | | PM Panda fiber | - |
| Operating Temperature | T | -40~85 | $^{\circ}$ C |
| Storage Temperature | T | -40~85 | $^{\circ}$ C |
| Package Dimension | | $\Phi 3.0 \times L54$ | mm |

Notice: Above specifications are tested at center wavelength without connector in room temperature @23 $^{\circ}$ C.

For devices with connectors, EL will be 0.2dB higher. ER will be 2dB lower, Connectors only 1W CW optical power guaranteee.

Slow axis is default aligned to the connector key.

Drawing:

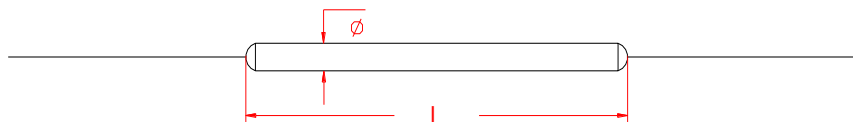

Ordering Information (Part Number):

| PMFIA- WWW - PP - AA - J - LL - CC | | | | | |
|--|-----------|--------------|----------------------|--------------|--------------|
| WWW | PP | AA | J | LL | CC |
| Wavelength | Port | Attenuation | Fiber Jacket | Fiber Length | Connector |
| 915 - 915nm | 11 - 1x1 | 01 - 1dB | B - 250um Bare Fiber | 05 - 0.5m | NE - None |
| 930 - 930nm | | 02 - 2dB | 9 - 900um Loose Tube | 10 - 1.0m | FA - FC/APC |
| 940 - 940nm | | 03 - 3dB | | 15 - 1.5m | FU - FC/UPC |
| 950 - 950nm | | 05 - 5dB | | 20 - 2.0m | SA - SC/APC |
| 975 - 975nm | | 10 - 10dB | | SS - Specify | SU - SU/APC |
| 980 - 980nm | | 15 - 15dB | | | LA - LC/APC |
| | | 20 - 20dB | | | LU - LC/UPC |
| | | 30 - 30dB | | | SS - Specify |
| | | SS - Specify | | | |