

1310nm RC80 1x3 3x3 SM Monolithic Fiber Fused Coupler

1310nm RC80 1x3 3x3 SM Monolithic Fiber Fused Coupler is built with fused biconical taper (FBT) technology, optical signal power can be splitted into three parts with even or various coupling ratio by the FBT Coupler, it's widely applied in fiber optic transmission and fiber optic sensor field, the Higher Power type is available upon request.

Application:

Optical Signal Transmission
Fiber Optic Sensor
CATV System
Optical Diffraction System

Features:

Low Excess Loss
High Return Loss
Low Insertion Loss
High Reliability



Specification:

Parameter	Symbol	Value	Unit
Center Wavelength	λ	1310	nm
Bandwidth	BW	± 40	nm
Max. Excess Loss	EL	0.15	dB
Max. Insertion Loss (For 1x3 Configuration)	IL	0.5/99/0.5	24.5/0.25/24.5
		1/98/1	21.5/0.25/21.5
		2.5/95/5	17.8/0.4/17.8
		5/90/5	14.7/0.65/14.7
		10/80/10	10.8/1.1/10.8
		15/70/15	9.0/2.1/9.0
		20/60/20	7.4/2.8/7.4
		25/50/25	6.6/3.4/6.6
		30/40/30	5.7/4.4/5.7
		33/33/33	5.4/5.4/5.4
		35/30/35	5.2/5.7/5.2
40/20/40	4.5/7.8/4.5		
Max. Polarization Dependent Loss	PDL	0.25	dB
Min. Directivity		50	dB
Min. Return Loss	RL	50	dB
Fiber Type		RC80 SMF fiber	-
Max. Tensile Load		5	N
Max. Optical Power (CW)	P	2	W
Operating Temperature	T	-40~75	°C
Storage Temperature	T	-40~85	°C
Package Dimension		$\Phi 3.0 \times L35$	mm

Notice: Above specifications are tested at center wavelength without connector in room temperature @23°C.

For devices with connectors, IL will be 0.3dB higher, RL will be 5dB lower, Connectors only 1W (Continue Wavelength) optical power guarantee.

Drawing:

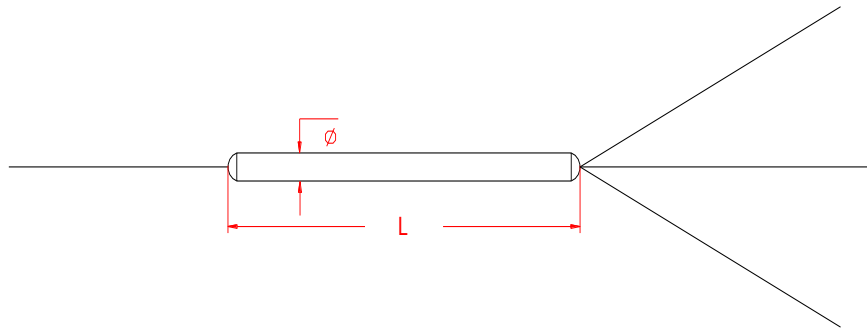

Ordering Information (Part Number):

RSMFUC-*WWW*-*PP*-*RR*-*J*-*LL*-*CC*

WWW	PP	RR	J	LL	CC
Wavelength	Port	Coupling Ratio	Fiber Jacket	Fiber Length	Connector
1310 - 1310nm	13 - 1x3	0.5 - 0.5/99/0.5	B - 250um Bare Fiber	05 - 0.5m	NE - None
1550 - 1550nm	33 - 3x3	01 - 1/98/1		10 - 1.0m	FA - FC/APC
		2.5 - 2.5/95/5		15 - 1.5m	FU - FC/UPC
		05 - 5/90/5		20 - 2.0m	SA - SC/APC
		10 - 10/80/10		SS - Specify	SU - SU/APC
		15 - 15/70/15			LA - LC/APC
		20 - 20/60/20			LU - LC/UPC
		25 - 25/50/25			SS - Specify
		30 - 30/40/30			
		33 - 33/33/33			
		35 - 35/30/35			
		40 - 40/20/40			
		SS - Specify			