

## High Power 1053nm PM Optical Isolator

High Power 1053nm Polarization Maintaining Optical Isolator is a fiber passive component built with TGG crystal, it allows light signal to be delivered in one forward direction and avoid the back reflection light, it's widely used in amplifier system, fiber optic sensor system to protect the light source and lower down the optical signal noise. The optical power can be up to 50W CW upon request, if need pulse type please contact us to confirm.

### Application:

Fiber Optic Amplifier  
Fiber Optic Sensor  
Fiber Laser  
Lab & Research

### Features:

High Power  
High Isolation  
Low Insertion Loss  
High Reliability



### Specification:

Parameter	Symbol	Value	Unit
Center Wavelength	$\lambda$	1053	nm
Bandwidth	BW	$\pm 5$	nm
Typ. Insertion Loss	IL	0.8	dB
Max. Insertion Loss	IL	1.0	dB
Typ. Peak Isolation	I <sub>iso</sub>	32	dB
Min. Isolation	I <sub>iso</sub>	25	dB
Min. Extinction Ratio for Fast Axis Blocked	ER	22	dB
Min. Extinction Ratio for Both Axes Working	ER	20	dB
Min. Return Loss	RL	45	dB
Max. Optical Power (CW)	P	1, 3, 5, 10, 20, 50 or specify	W
Max. Peak Power	P	5, 10, 20 or specify	KW
Max. Tensile Load		5	N
Fiber Type		PM Panda Fiber	-
Operating Temperature	T	+10~50	°C
Storage Temperature	T	0~60	°C
Package Dimension			mm

Notice: Above specifications are tested at center wavelength without connector in room temperature @23°C.

For devices with connectors, IL will be 0.3dB higher, RL will be 5dB lower. ER will be 2dB lower.

Slow axis is default aligned to the connector key. Connectors only 1W CW optical power guarantee.

### Drawing:

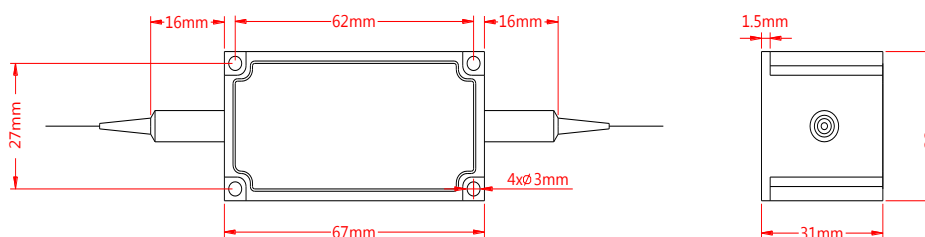

### Ordering Information (Part Number):

HPMISO-**WWW**-**A**-**HH**-**J**-**LL**-**CC**

<b>WWW</b>	<b>A</b>	<b>HH</b>	<b>J</b>	<b>LL</b>	<b>CC</b>
Wavelength	Working Axis	Handling Power	Fiber Jacket	Fiber Length	Connector
1030 - 1030nm	F - Fast axis Blocked Slow Axis working	01 - 1W	B - 250um Bare Fiber 9 - 900um Loose Tube	05 - 0.5m	NE - None
1040 - 1040nm		03 - 3W		10 - 1.0m	FA - FC/APC
1050 - 1050nm	B - Both Axes Working	05 - 5W		15 - 1.5m	FU - FC/UPC
1053 - 1053nm		10 - 10W		20 - 2.0m	SA - SC/APC
1060 - 1060nm		20 - 20W		SS - Specify	SU - SU/APC
1064 - 1064nm		50 - 50W			LA - LC/APC
1080 - 1080nm		SS - Specify			LU - LC/UPC