

High Power 850±50nm Broadband Polarization Insensitive Optical Isolator

High Power 850±50nm Broadband Polarization Insensitive Optical Isolator is a fiber passive component built with TGG crystal, it allows light signal to be delivered in one forward direction and avoid the back reflection light, it's widely used in OCT system, fiber optic sensor system to protect the light source and lower down the system optical signal noise. The higher power type is available upon request, if need pulse type please contact us to confirm.

Application:

OCT
Fiber Optic Sensor
Fiber Laser
Lab & Research

Features:

High Isolation
High Power
Low Insertion Loss
High Reliability



Specification:

| Parameter | Symbol | Value | Unit |
|----------------------------------|-----------|-------------------------------|------|
| Center Wavelength | λ | 850 | nm |
| Bandwidth | BW | ±50 | nm |
| Typ. Insertion Loss | IL | 0.9 | dB |
| Max. Insertion Loss | IL | 1.4 | dB |
| Typ. Peak Isolation | Iso | 25 | dB |
| Min. Isolation | Iso | 18 | dB |
| Max. Polarization Dependent Loss | PDL | 0.2 | dB |
| Min. Return Loss | RL | 50 | dB |
| Max. Optical Power (CW) | P | 1, 3, 5, 10, 20 or customized | W |
| Max. Peak Power | P | 5, 10 or customized | kW |
| Max. Tensile Load | | 5 | N |
| Fiber Type | | HI 780 fiber | - |
| Operating Temperature | T | +5~65 | °C |
| Storage Temperature | T | -40~85 | °C |
| Package Dimension | | | mm |

Notice: Above specifications are tested without connector in room temperature @23°C.

For devices with connectors, IL will be 0.3dB higher, RL will be 5dB lower. Connectors only 1W CW guarantee.

Drawing:

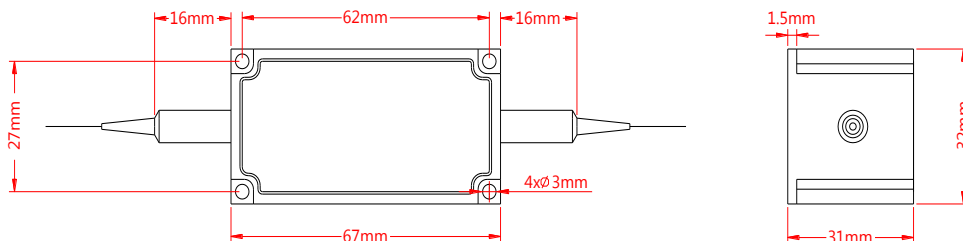

Ordering Information (Part Number):

HBPII-**WWW**-**HH**-**FF**-**J**-**LL**-**CC**

| WWW | HH | FF | J | LL | CC |
|---------------|----------------|--------------|----------------------|--------------|--------------|
| Wavelength | Handling Power | Fiber Type | Fiber Jacket | Fiber Length | Connector |
| 850 - 850nm | 01 - 1W | H7 - HI 780 | B - 250um Bare Fiber | 05 - 0.5m | NE - None |
| SSS - Specify | 03 - 3W | SS - Specify | 9 - 900um Loose Tube | 10 - 1.0m | FA - FC/APC |
| | 05 - 5W | | | 15 - 1.5m | FU - FC/UPC |
| | 10 - 10W | | | 20 - 2.0m | SA - SC/APC |
| | 20 - 20W | | | SS - Specify | SU - SU/APC |
| | SS - Specify | | | | LA - LC/APC |
| | | | | | LU - LC/UPC |
| | | | | | SS - Specify |