

## High Power 790±20nm Broadband PM Optical Isolator

High Power 790± 20nm Broadband Polarization Maintaining Optical Isolator is a fiber passive component built with TGG crystal, it allows light signal to be delivered in one forward direction and avoid the back reflection light, it's widely used in amplifier system, fiber optic sensor system to protect the light source and lower down the system optical signal noise. The higher power type is available upon request, if need pulse type please contact us to confirm.

### Application:

Fiber Optic Amplifier  
Fiber Optic Sensor  
Fiber Laser  
Lab & Research

### Features

High Power  
High Isolation  
Wide Band  
High Reliability



### Specification:

Parameter	Symbol	Value	Unit
Center Wavelength	$\lambda$	790	nm
Bandwidth	BW	±20	nm
Typ. Insertion Loss	IL	0.9	dB
Max. Insertion Loss	IL	1.5	dB
Typ. Peak Isolation	Iso	35	dB
Min. Isolation	Iso	25	dB
Min. Extinction Ratio for Fast Axis Blocked	ER	20	dB
Min. Extinction Ratio for Both Axes Working	ER	18	dB
Min. Return Loss	RL	50	dB
Max. Optical Power (CW)	P	1, 3, 5 or specify	W
Max. Peak Power	P	5, 10 or specify	KW
Max. Tensile Load		5	N
Fiber Type		PM Panda Fiber	-
Operating Temperature	T	+5~65	°C
Storage Temperature	T	-40~85	°C
Package Dimension			mm

Notice: Above specifications are tested without connector in room temperature @23°C.

For devices with connectors, IL will be 0.3dB higher, RL will be 5dB lower. ER will be 2dB lower.

Slow axis is default aligned to the connector key. Connectors only 1W CW optical power guarantee.

### Drawing:

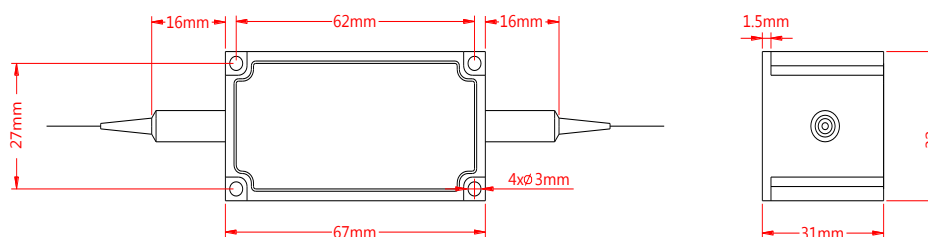

### Ordering Information (Part Number):

**HBPMI-*WWW*-*A*-*HH*-*J*-*LL*-*CC***

<b>WWW</b>	<b>A</b>	<b>HH</b>	<b>J</b>	<b>LL</b>	<b>CC</b>
Wavelength	Working Axis	Handling Power	Fiber Jacket	Fiber Length	Connector
780 - 780nm	F - Fast axis Blocked Slow Axis working	01 - 1W	B - 250um Bare Fiber	05 - 0.5m	NE - None
785 - 785nm		03 - 3W	9 - 900um Loose Tube	10 - 1.0m	FA - FC/APC
790 - 790nm	B - Both Axes Working	05 - 5W		15 - 1.5m	FU - FC/UFC
793 - 793nm		SS - Specify		20 - 2.0m	SA - SC/APC
SSS - Specify				SS - Specify	SU - SU/APC
					LU - LC/UFC
					SS - Specify