

## 633nm PM Optical Isolator

633nm PM Optical Isolator is a fiber passive component built with TGG crystal, it allows light signal to be delivered in one forward direction and avoid the back reflection light, it's widely used in amplifier system, fiber optic sensor system to protect the light source and lower down the system optical signal noise. The high power type is available upon request.

### Application:

Quantum Communication  
Fiber Laser  
Coherent Detecting  
Fiber Optic Amplifier

### Features:

High Isolation  
Low PDL  
Low Insertion Loss  
High Reliability



### Specification:

Parameter	Symbol	Value	Unit
Center Wavelength	$\lambda$	633	nm
Bandwidth	BW	$\pm 5$	nm
Typ. Insertion Loss	IL	0.8	dB
Max. Insertion Loss	IL	1.2	dB
Typ. Peak Isolation	Iso	25	dB
Min. Isolation	Iso	22	dB
Min. Extinction Ratio	ER	18	dB
Min. Return Loss	RL	45	dB
Max. Optical Power (CW)	P	300 or customized	mW
Max. Tensile Load		5	N
Fiber Type		Nufern PM630-HP fiber	-
Operating Temperature	T	+10~50	$^{\circ}\text{C}$
Storage Temperature	T	0~60	$^{\circ}\text{C}$
Package Dimension			mm

Notice: Above specifications are tested at center wavelength without connector in room temperature @23  $^{\circ}\text{C}$ .

For devices with connectors, IL will be 0.3dB higher, ER will be 2dB lower, RL will be 5dB lower.

### Drawing:

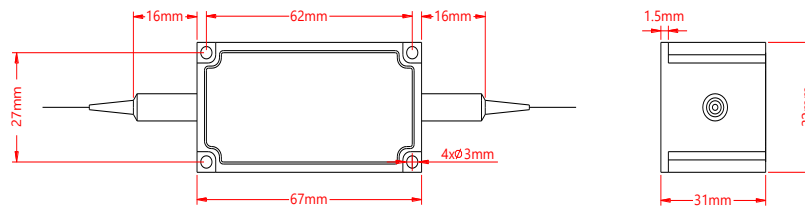

### Ordering Information (Part Number):

PMISO-**WWW**-**A**-**J**-**LL**-**CC**

<b>WWW</b>	<b>A</b>	<b>J</b>	<b>LL</b>	<b>CC</b>
Wavelength	Working Axis	Fiber Jacket	Fiber Length	Connector
633 - 633nm	F - Fast Axis Blocked Slow Axis Working	B - 250um Bare Fiber	05 - 0.5m	NE - None
635 - 635nm		9 - 900um Loose Tube	10 - 1.0m	FA - FC/APC
640 - 640nm	B - Both Axes Working		15 - 1.5m	FU - FC/UPC
650 - 650nm			20 - 2.0m	SA - SC/APC
680 - 680nm			SS - Specify	SU - SU/APC
SSS - Specify				LA - LC/APC
				LU - LC/UPC
				SS - Specify